

Retail access

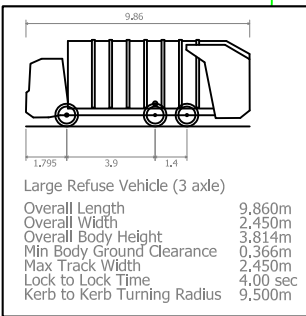
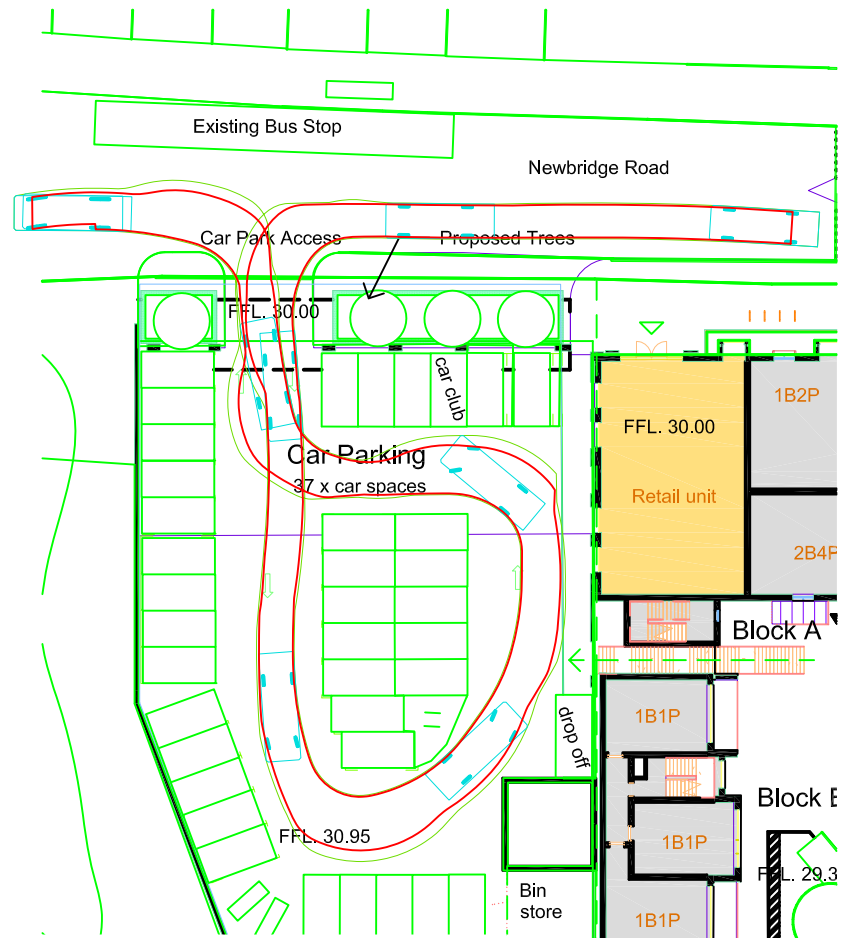
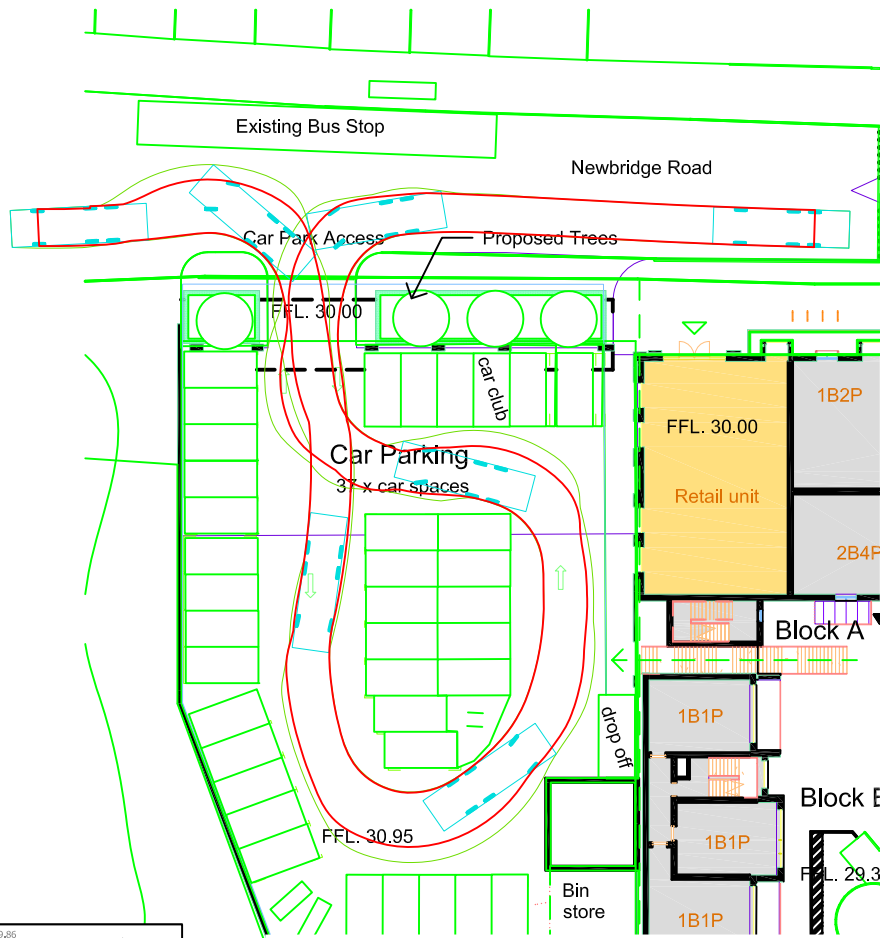

Framework Management Plan:

"Retail Element"

4.3 Servicing will be from the decked parking area adjacent to the retail space, and is expected to be infrequent. Goods will be transported between the loading area and the commercial unit by cages or trollies. Dropped kerbs will be provided within the site, if required, to enable trollies to be transported easily. Delivery companies will be informed of any restrictions prior to appointment so that a suitably-sized vehicle can be used.

4.4 A bin store will be provided for the commercial unit within the decked car park. Refuse will be kept in the bin store until collection day, at which point refuse bins will be moved by the unit occupier to an agreed location within the car park or on the roadside for collection."

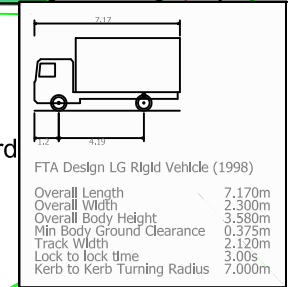

Maltings service access

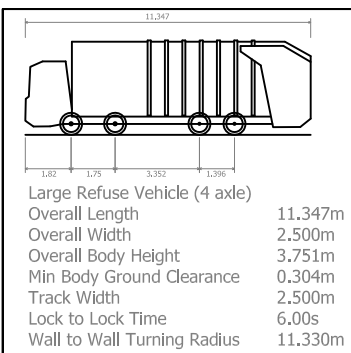
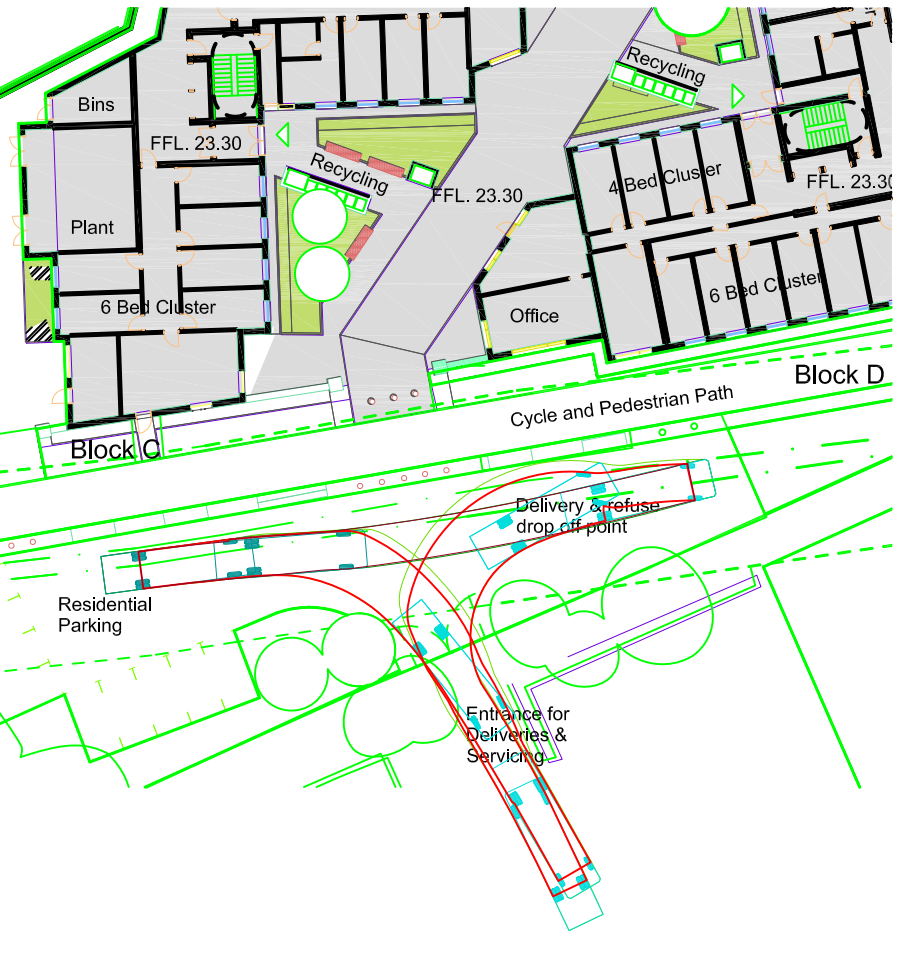
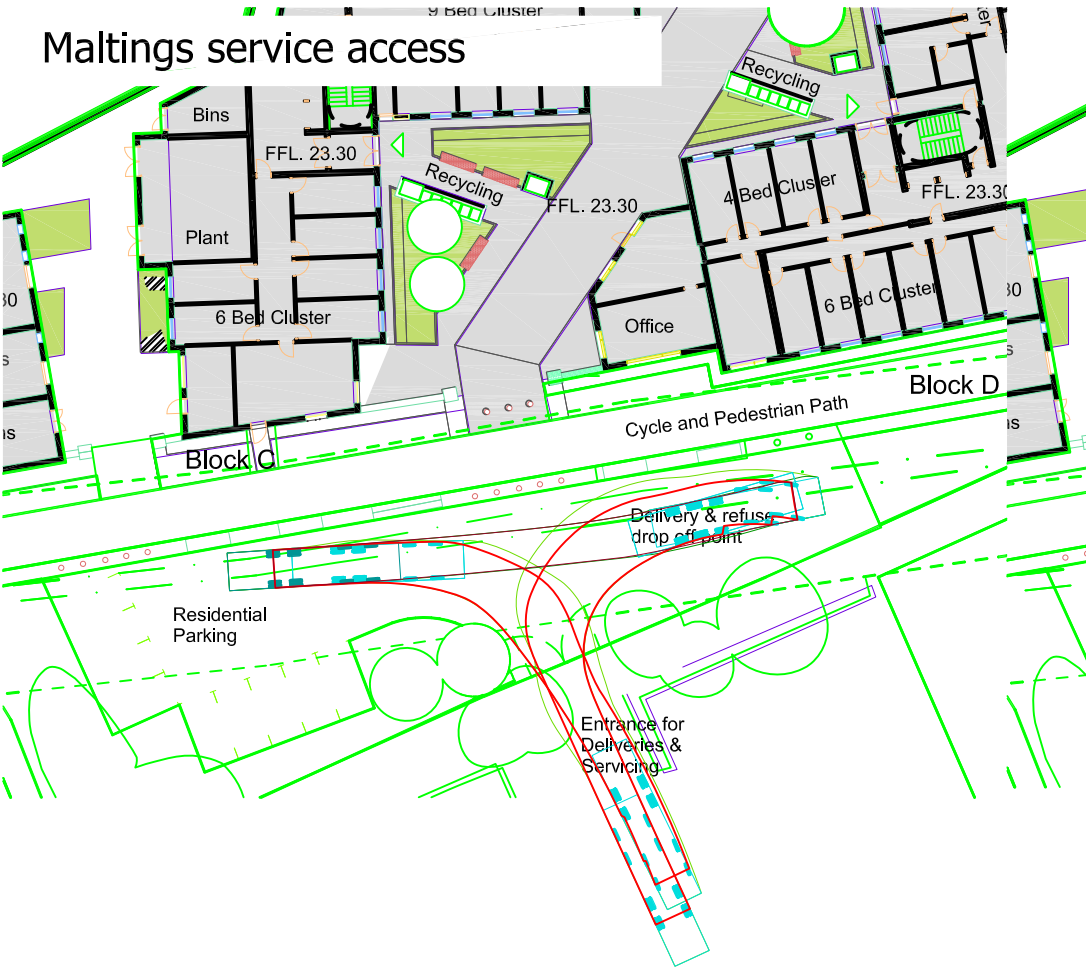

Framework Management Plan:

"Servicing Arrangements"

3.11 The access ramp service from Newbridge Road is suitable for cars or vans only. Larger service vehicles, refuse, and emergency vehicles will access the site from The Maltings Industrial Estate to the south of the site. The access will be secured via a gate, and the plans identify a clear delivery / drop off area and refuse pick up point. The site management office has deliberately been located adjoining this area and residential deliveries will be controlled by the Management Team.

3.12 Communal refuse areas will be located across the site, convenient for all residential occupiers. The Management Company will take responsibility for moving the refuse bins to the refuse collection area on collection day."

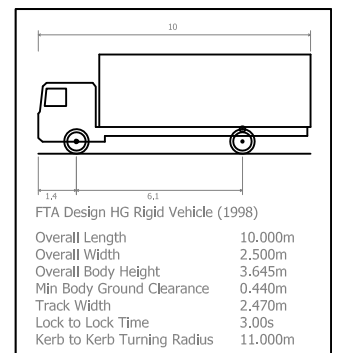

© Crown copyright and database rights 2019. Ordnance Survey 0100031673



Mayer Brown Limited
 Suite 501 CityPoint Temple Gate Bristol BS1 6PL
 Telephone 0117 9251027 Fax 0117 9251029
 bristoloffice@mayerbrown.co.uk www.mayerbrown.co.uk

client
OAKHILL GROUP LIMITED
 title
**NEWBRIDGE ROAD, BATH
 SWEEP PATH ANALYSIS**

scale **1:500 @ A3** | drawn by **HI** | checked by **RG**

date **JUNE 2019** | cad file **02.dwg**

drawing number **B/WPBath2.1/02** | rev. **-**