

This drawing shall not be scaled.  
Work from the dimensions shown in the drawing or given in relevant specifications.



**CDM Regulations:**  
In addition to any information included in this drawing or the model from which it is derived, refer also to the project CDM Risk Register for information on residual risks.

**General Notes:**

- The drawing does not necessarily show all the information needed to interpret the design intent or the construction details.
- The drawing contains information from more than one source and must be read in conjunction with all relevant specifications.
- Any apparent drafting errors and differences between other drawings and specifications shall be brought to our attention.

**Project Notes:**

**LEGEND**

<span style="color: green;">■</span>	UNHEATED
<span style="color: cyan;">■</span>	ELECTRIC PANEL HEATER
<span style="color: yellow;">■</span>	VRF SYSTEM
<span style="color: orange;">■</span>	RADIATOR

P2	PRELIMINARY ISSUE	RS	CW	VO	03/19
P1	PRELIMINARY ISSUE	RS	CW	VO	08/03
Index	Description	Designed	Reviewed	Authorised	Date

REVISIONS:



**ARCHITECT:**  
AWW

**CLIENT:**  
Oakhill Group Ltd

**PROJECT TITLE:**  
Newbridge Road Bath

**DRAWING TITLE:**  
MECHANICAL ENGINEERING SYSTEMS  
SPACE HEATING  
LOWER GROUND

**PRELIMINARY ISSUE**

<b>PERSON RESPONSIBLE FOR:</b>		
Design: XX	Review: XX	Authorising Issue: XX
Project No: 0512194	Date: MARCH 2019	Scale @ A1: 1:200 @ A1
<b>DRAWING NUMBER:</b>		Revision:
0512194-HL-XX-LG-DR-M-560-6001		P2

This drawing shall not be scaled.  
Work from the dimensions shown in the drawing or given in relevant specifications.

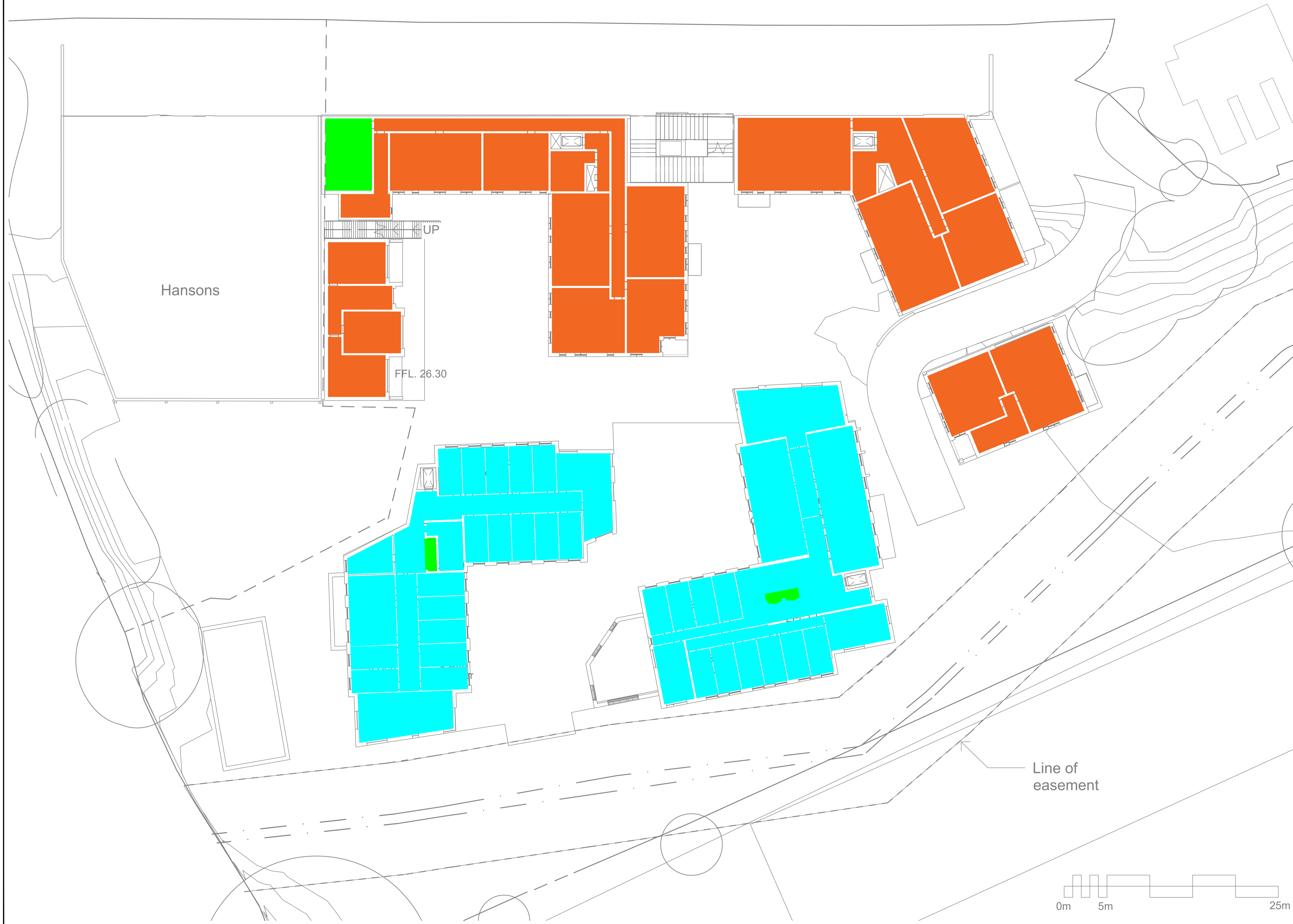

CDM Regulations:

In addition to any information included in this drawing or the model from which it is derived, refer also to the project CDM Risk Register for information on residual risks.

General Notes:

- The drawing does not necessarily show all the information needed to interpret the design intent or the construction details.
- The drawing contains information from more than one source and must be read in conjunction with all relevant specifications.
- Any apparent drafting errors and differences between other drawings and specifications shall be brought to our attention.

Project Notes:

LEGEND

	UNHEATED
	ELECTRIC PANEL HEATER
	VRF SYSTEM
	RADIATOR

P2	PRELIMINARY ISSUE	RS	CW	VO	03/19
P1	PRELIMINARY ISSUE	RS	CW	VO	08/03
Index	Description	Designed	Reviewed	Authorised	Date

REVISIONS:



ARCHITECT:  
AWW

CLIENT:  
Oakhill Group Ltd

PROJECT TITLE:  
Newbridge Road Bath

DRAWING TITLE:  
MECHANICAL ENGINEERING SYSTEMS  
SPACE HEATING  
LEVEL -1

PRELIMINARY ISSUE

PERSON RESPONSIBLE FOR:		
Design: XX	Review: XX	Authorising Issue: XX

Project No: 0512194	Date: MARCH 2019	Scale @ A1: 1:200 @ A1
------------------------	---------------------	---------------------------

DRAWING NUMBER: 0512194-HL-XX-LG-DR-M-560-6002	Revision: P2
---	-----------------

A1  
 This drawing shall not be scaled.  
 Work from the dimensions shown in the drawing or given in relevant specifications.



**CDM Regulations:**  
 In addition to any information included in this drawing or the model from which it is derived, refer also to the project CDM Risk Register for information on residual risks.

**General Notes:**

- The drawing does not necessarily show all the information needed to interpret the design intent or the construction details.
- The drawing contains information from more than one source and must be read in conjunction with all relevant specifications.
- Any apparent drafting errors and differences between other drawings and specifications shall be brought to our attention.

**Project Notes:**

**LEGEND**

	UNHEATED
	ELECTRIC PANEL HEATER
	VRF SYSTEM
	RADIATOR

P2	PRELIMINARY ISSUE	RS	CW	VO	03/19
P1	PRELIMINARY ISSUE	RS	CW	VO	08/03
Index	Description	Designed	Reviewed	Authorised	Date

REVISIONS:



**ARCHITECT:**  
 AWW

**CLIENT:**  
 Oakhill Group Ltd

**PROJECT TITLE:**  
 Newbridge Road  
 Bath

**DRAWING TITLE:**  
 MECHANICAL ENGINEERING SYSTEMS  
 SPACE HEATING  
 GROUND FLOOR

**PRELIMINARY ISSUE**

**PERSON RESPONSIBLE FOR:**

Design: RS	Review: CW	Authorising Issue: VO
Project No: 0512194	Date: MARCH 2019	Scale @ A1: 1:200 @ A1
DRAWING NUMBER: 0512194-HL-XX-00-DR-M-560-6003		Revision: P2

A1  
 This drawing shall not be scaled.  
 Work from the dimensions shown in the drawing or given in relevant specifications.

CDM Regulations:  
 In addition to any information included in this drawing or the model from which it is derived, refer also to the project CDM Risk Register for information on residual risks.

General Notes:  
 • The drawing does not necessarily show all the information needed to interpret the design intent or the construction details.  
 • The drawing contains information from more than one source and must be read in conjunction with all relevant specifications.  
 • Any apparent drafting errors and differences between other drawings and specifications shall be brought to our attention.

Project Notes:

- LEGEND
- UNHEATED
  - ELECTRIC PANEL HEATER
  - VRF SYSTEM
  - RADIATOR



P2	PRELIMINARY ISSUE	RS	CW	VO	03/19
P1	PRELIMINARY ISSUE	RS	CW	VO	08/03
Index	Description	Designed	Reviewed	Authorised	Date

REVISIONS:



ARCHITECT:  
AWW

CLIENT:  
Oakhill Group Ltd

PROJECT TITLE:  
Newbridge Road  
Bath

DRAWING TITLE:  
MECHANICAL ENGINEERING SYSTEMS  
SPACE HEATING  
FIRST FLOOR

**PRELIMINARY ISSUE**

PERSON RESPONSIBLE FOR:

Design: XX	Review: XX	Authorising Issue: XX
---------------	---------------	--------------------------

Project No: 0512194	Date: MARCH 2019	Scale @ A1: 1:200 @ A1
------------------------	---------------------	---------------------------

DRAWING NUMBER: 0512194-HL-XX-01-DR-M-560-6004	Revision: P2
---	-----------------



This drawing shall not be scaled.  
Work from the dimensions shown in the drawing or given in relevant specifications.

CDM Regulations:  
In addition to any information included in this drawing or the model from which it is derived, refer also to the project CDM Risk Register for information on residual risks.

General Notes:  
• The drawing does not necessarily show all the information needed to interpret the design intent or the construction details.  
• The drawing contains information from more than one source and must be read in conjunction with all relevant specifications.  
• Any apparent drafting errors and differences between other drawings and specifications shall be brought to our attention.

Project Notes:

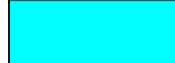
LEGEND

	UNHEATED
	ELECTRIC PANEL HEATER
	VRF SYSTEM
	RADIATOR



P2	PRELIMINARY ISSUE	RS	CW	VO	03/19
P1	PRELIMINARY ISSUE	RS	CW	VO	08/03
Index	Description	Designed	Reviewed	Authorised	Date

REVISIONS:



ARCHITECT:  
AWW

CLIENT:  
Oakhill Group Ltd

PROJECT TITLE:  
Newbridge Road Bath

DRAWING TITLE:  
MECHANICAL ENGINEERING SYSTEMS  
SPACE HEATING  
SECOND FLOOR

PRELIMINARY ISSUE

PERSON RESPONSIBLE FOR:

Design:	Review:	Authorising Issue:
XX	XX	XX

Project No:	Date:	Scale @ A1:
0512194	MARCH 2019	1:200 @ A1

DRAWING NUMBER:	Revision:
0512194-HL-XX-02-DR-M-560-6005	P2

